

GUARDA-CORPO / CORRIMÃO

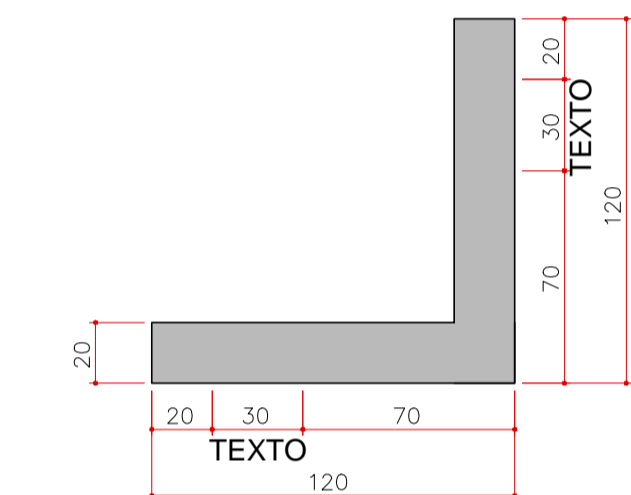
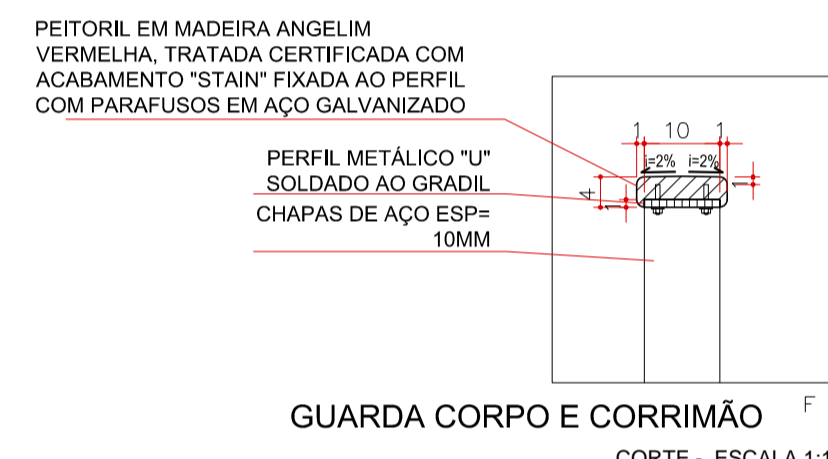
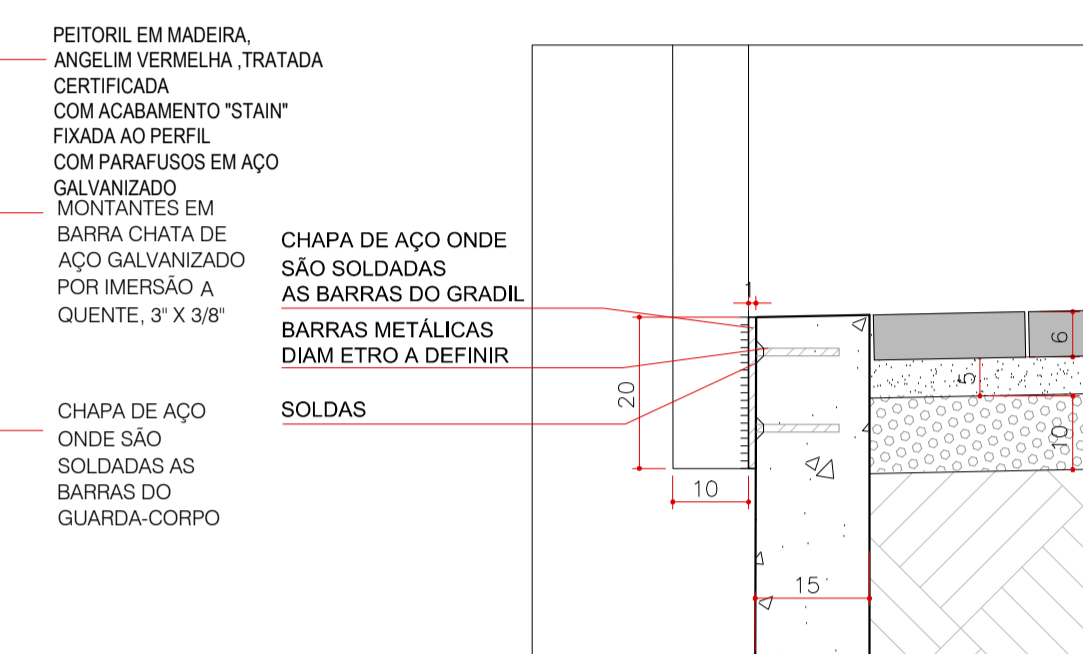
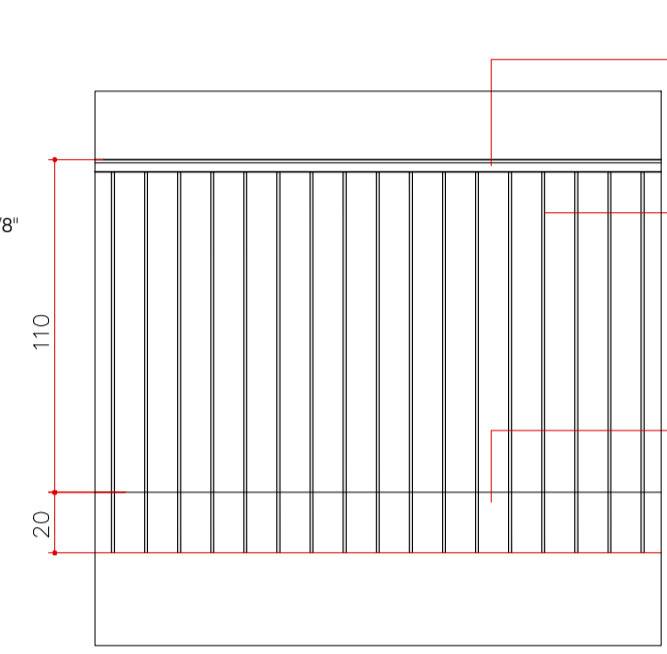
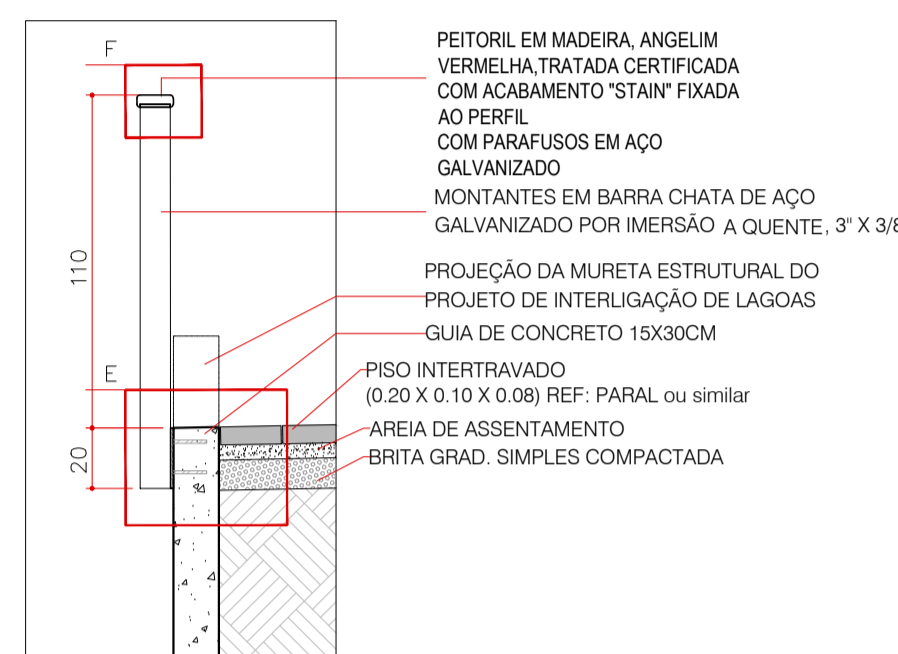
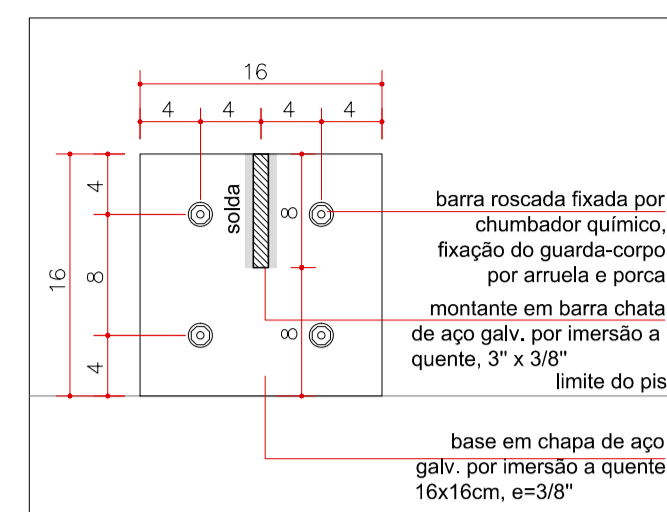
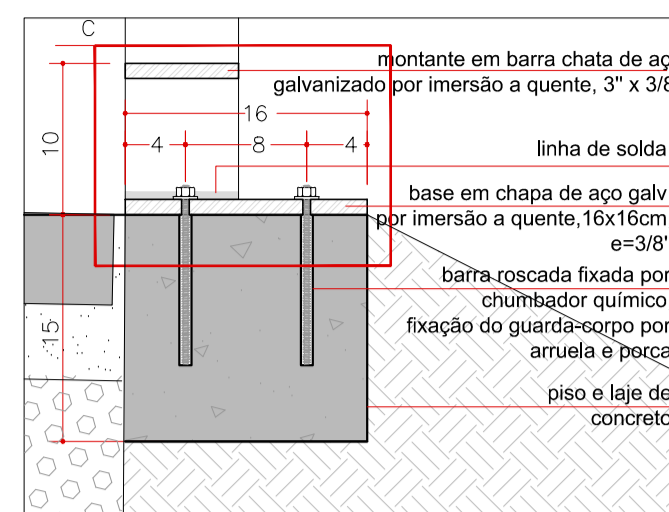
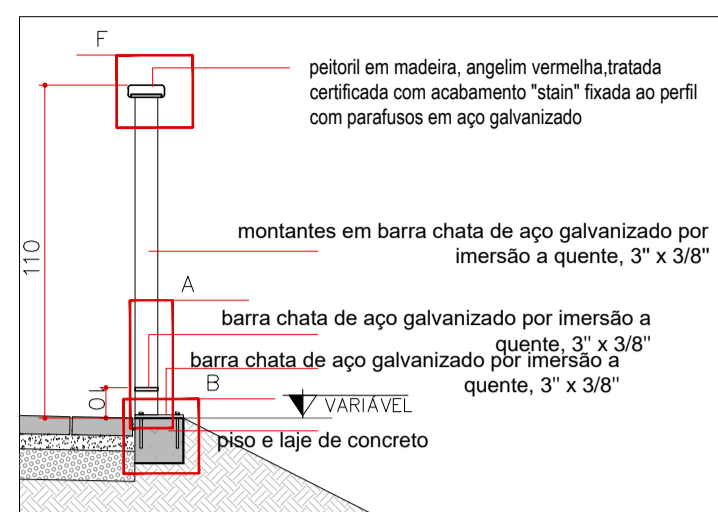

PLANTA

TEXTOS IMPLANTADOS COM A TÉCNICA DE ESTÊNCEL (STENCIL). PINTURA EM SPRAY SOBRE MOLDE PERFURADO (FACA), COR GRAFITE.

PAINEL DE CONCRETO ARMADO PRE MOLDADO

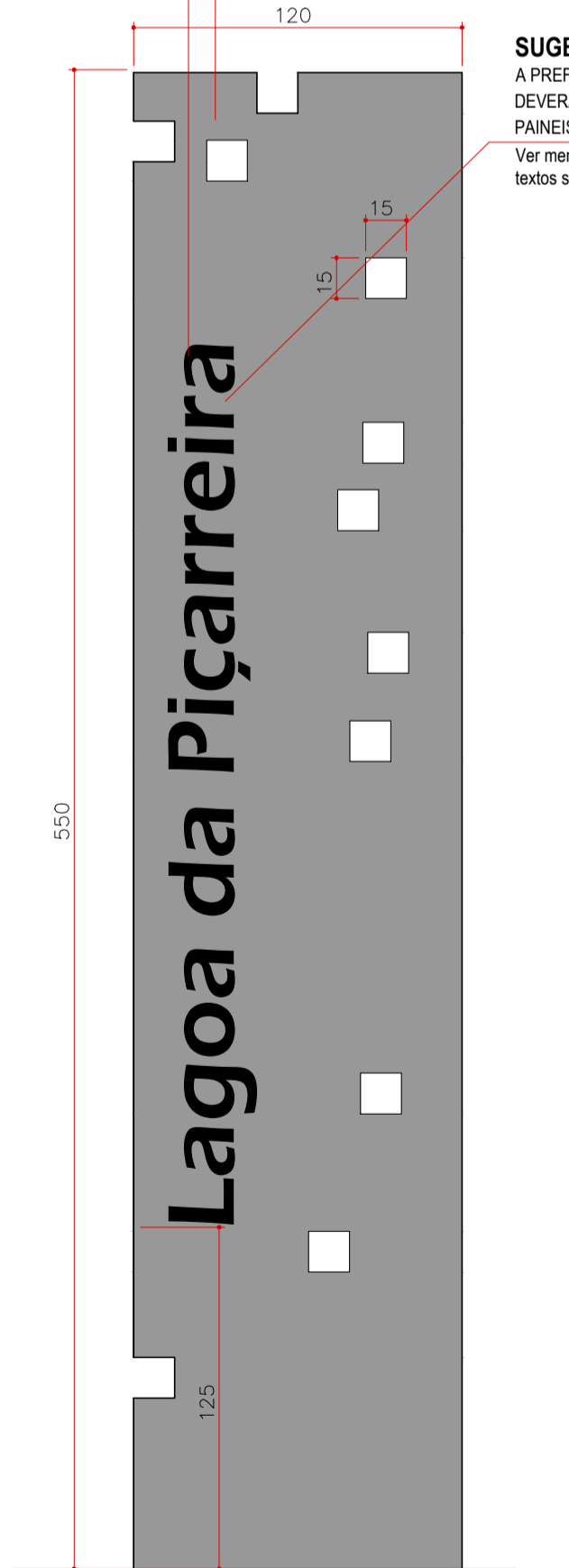

PAINEL INFORMATIVO GRANDE IDENTIFICAÇÃO - CV01

DETALHE PLACAS DE COMUNICAÇÃO VISUAL
ESCALA 1:25

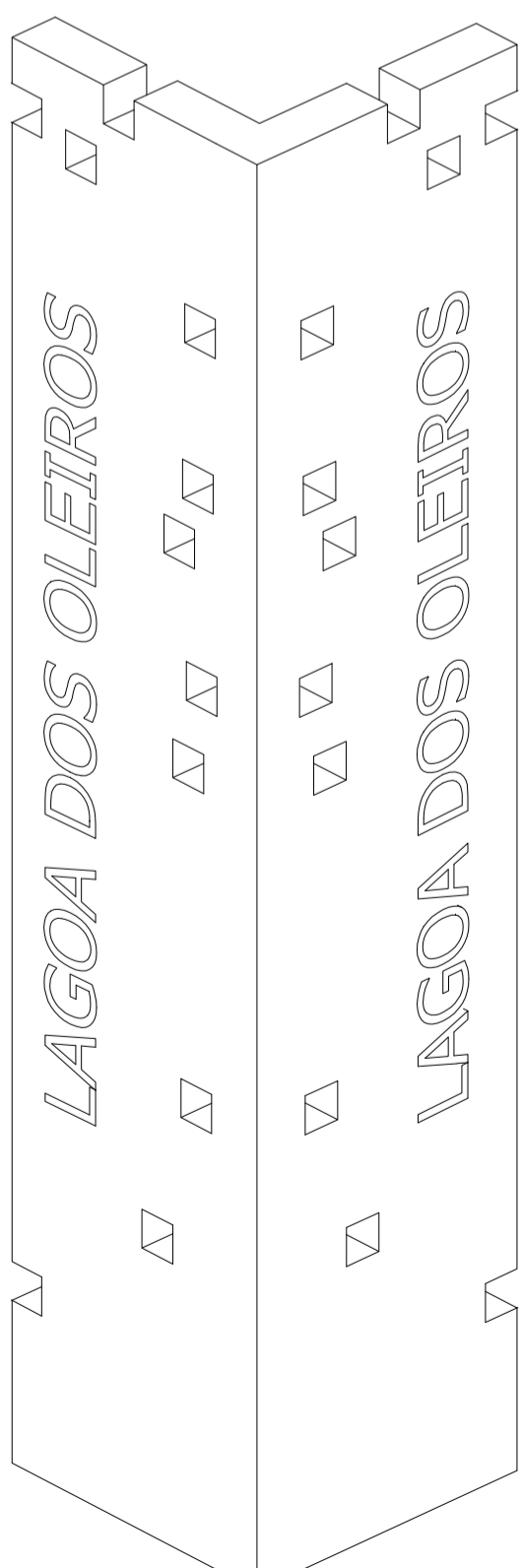

PAINEL INFORMATIVO GRANDE IDENTIFICAÇÃO - CV01

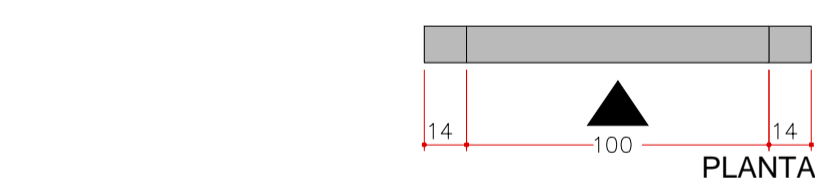

PAINEL INFORMATIVO MEDIO DIRECCIONAL - CV02

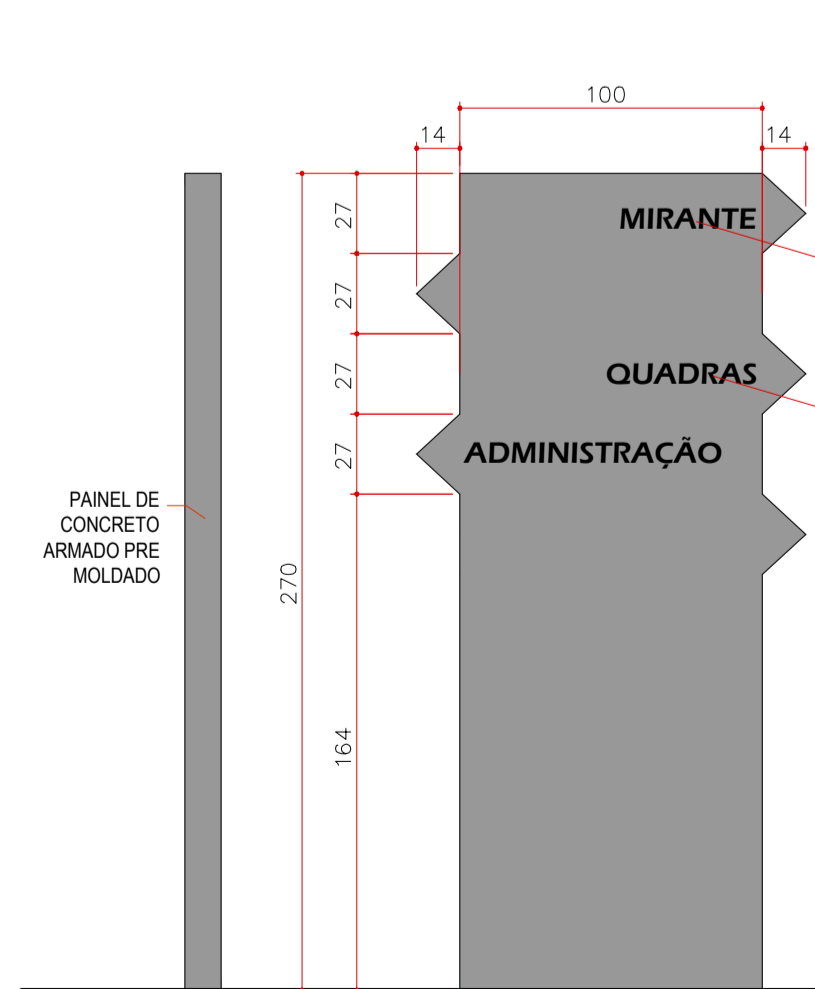

PAINEL INFORMATIVO MEDIO DIRECCIONAL - CV02

DETALHE PLACAS DE COMUNICAÇÃO VISUAL
ESCALA 1:25

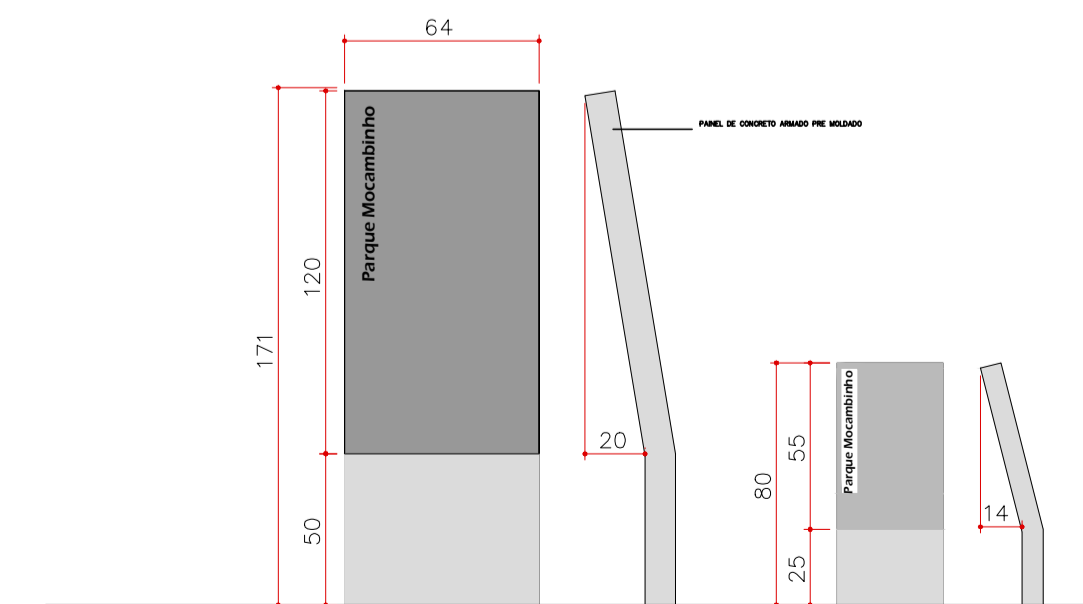

PAINEL INFORMATIVO MEDIO - CV03

DETALHE PLACAS DE COMUNICAÇÃO VISUAL
ESCALA 1:25

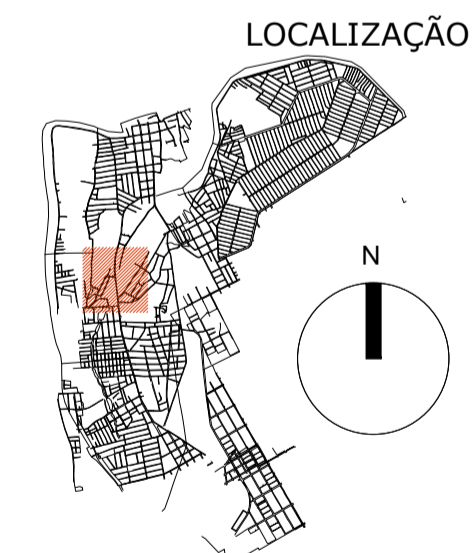

ROD	EMISSÃO INICIAL	MAI/2017		
Nº	REVISÃO	DATA	Nº	REVISÃO
MPB SANEAMENTO LTDA/ JANSANA DE LA VILLA DE PAALW ARCHITECTES		PROJETO	DATA	
CENTRO URBANÍSTICO DE TERESINA - PI - ÁREA 24 - Nº 32233682		DESENHO	DATA	
CENTRO - FLORIANÓPOLIS - SC		CONFERIDO	DATA	
www.mpb.org.br - sp@mpb.org.br		APROVADO	DATA	
DATA	ASSINATURA	Nº DA CONSULTORA		

PREFEITURA MUNICIPAL DE TERESINA - PI
TERESINA - PI
PROJETOS BÁSICOS E EXECUTIVOS DAS OBRAS DE REQUALIFICAÇÃO URBANA E AMBIENTAL DAS ÁREAS 2,3 E 4, INCLUINDO PLANO DE REASSENTAMENTO, DO MUNICÍPIO DE TERESINA - PI

RP-5 PROJETO URBANÍSTICO EXECUTIVO
DETALHES: MOBILIÁRIO, GUARDACORPO
P9-OLEIROS, PIÇARREIRA, SÃO JOAQUIM, MAZERINE